



Measuring should be done by the person installing the countertop. Customers who provide their own measurements are more tolerant of small errors.

Measuring does require some special care. Custom countertops are one of a kind; if they don't fit, re-work is very expensive or could be impossible.

A. HOW TO MEASURE FOR PROPER FIT

If installing new cabinets, always measure after the base cabinets are set.

If the countertop only is being replaced, simply measure the old countertop (unless changing the configuration).

Measure the cabinets that will be covered with the countertop. When measuring the countertop, you should always measure to the back wall of the countertop for the most accurate measurements.

B. HOW TO DETERMINE DEPTH

Standard kitchen base cabinets measure 24" deep. A standard 25¼" top will give about 1¼" of overhang at the front. A standard 25" top will give about 1" overhang at the front.

For an island top (not against a wall), you want that 1¼" overhang on each side. If you want an island with seating at the counter, specify the size that will provide overhang on one side for knee space.

Mark the length of each countertop to your drawings. Be sure to mark the depth of each leg section, so we know whether it's a kitchen (25" or 25¼"), vanity (19" or 22½") or bar top (12" and up). See specification sheets example.

To determine the length of each countertop section, measure along the wall directly behind the existing countertop or new cabinet.

Rules for determining countertop overhang to be added to cabinet measurements:

- a. Countertop end that is open and capped: allow 1" overhang.
- b. Countertop butts to an appliance: allow ⅛" overhang.
- c. Countertop butts to a wall/cabinet: allow no overhang.

Note: Each finished applied end cap adds ⅛" to top length. Each butt splash (butts up against the end of the countertop) adds 13⁄16" to the top length.

C. IRREGULAR WALLS – OUT-OF-SQUARE MITER CORNERS:

Hartson-Kennedy countertops have a 3⁄8" scribe on the backsplash that can be sanded to fit slightly irregular (bowed or cupped) walls.

Waterfall and No-Drip 25¼" kitchen tops manufactured at Marion, Indiana plant have a 5⁄8" scribe on the backsplash.

To determine whether corner walls are square:

- a. Place a mark on one wall 36" from the corner.
- b. Place a mark on opposite wall 48" from corner.
- c. Measure the diagonal between the two marks - making sure to hold both ends of the tape measure exactly on each mark and to eliminate any "bow" or "slack" in the tape (which has the effect of artificially increasing the measurement of the diagonal). This procedure is known as taking a "3-4-5" and is a good method to ensure the countertop fits into the corner. The diagonal measurement will always be exactly 60" if the wall is 90 degrees and there are no cups or bows in the walls of the corner.



D. MARK THE END TREATMENT

Mark the end treatment desired. On all tops, designate whether ends are finished (capped) or unfinished (raw).

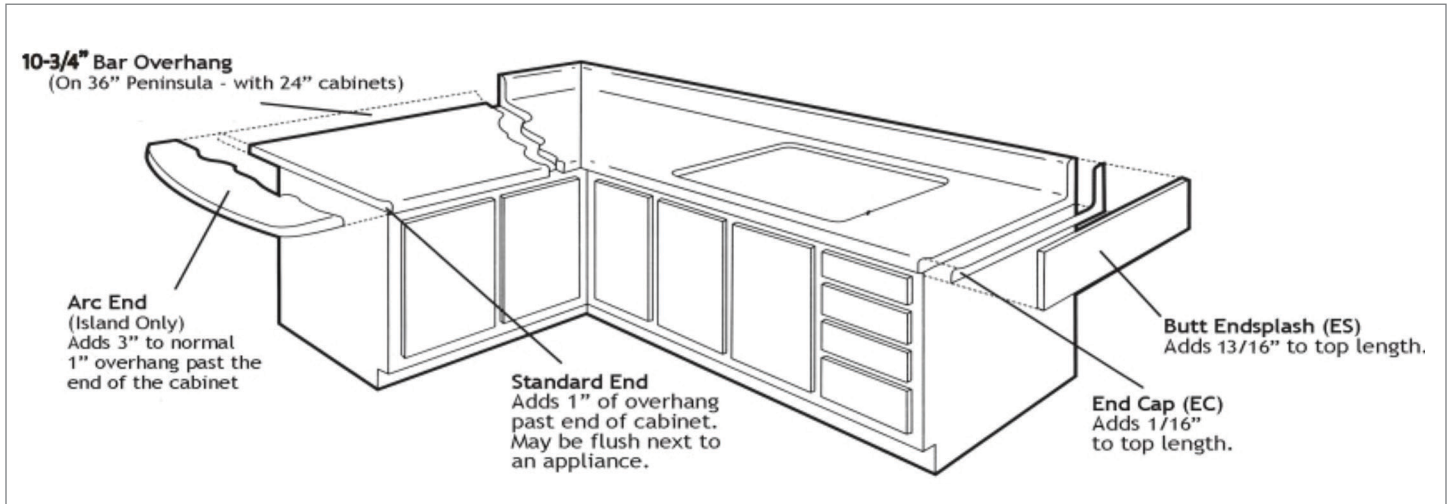

E. CUTOUTS

Measuring for cutouts requires adherence to three fundamental rules:

- Always measure to and specify the centerline of the cutout (specify from which side you are measuring - left-hand or right-hand).
- Always refer to and specify the bowl or cooktop manufacturer's brand name, model number, and cutout specifications.
- **When a sink cutout falls on a seam in a postform countertop, the seam should be relocated. It is almost certain that a serious water damage problem(s) will result in the seam if this is not done.**

Note: Moisture (water) damage is not covered under warranty.



Diagonal Corners – Based on 24” deep cabinets

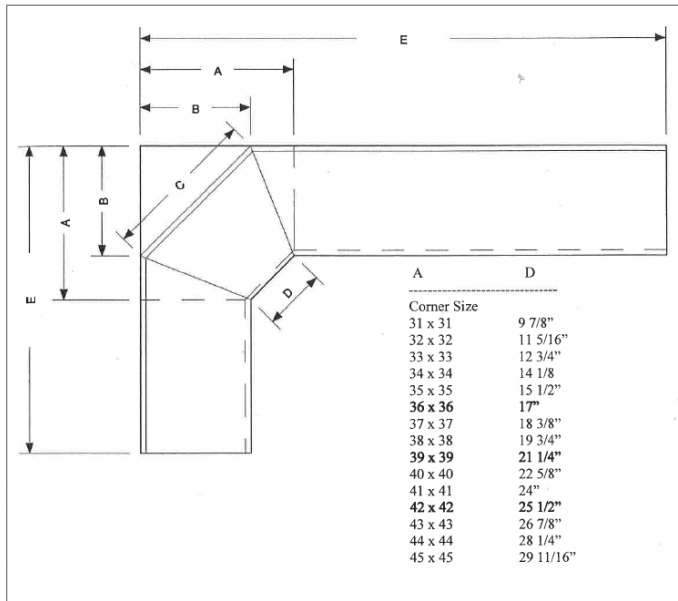

When ordering a countertop with a diagonal corner, always specify by dimension A on the chart above.

Dimension A — These must always be alike. Revolving tray cabinets are designed 36" x 36", etc. When using a sink-front or regular cabinet instead of a revolving tray, the cabinets on both sides must be spaced the same from wall.

Note: 32" x 21" bowl requires a minimum of 44" x 44" space with 30" sink front cut down to 28 1/4".

Dimension B — Size of shelf is always 10" smaller than dimension A.

Dimension C — Length of center countertop at backsplash.

The surface on which "C" appears is a triangular shelf at the top of the backsplash height.

Dimension D — Represents the cabinet front.

Dimension E — Always give the **overall** dimensions as the size of your countertop.

Diagonal corner countertops without the raised shelf (see drawing below). The diagonal corner without shelf is often requested when a sink is being used in the corner. This is a more difficult construction and is not available everywhere.

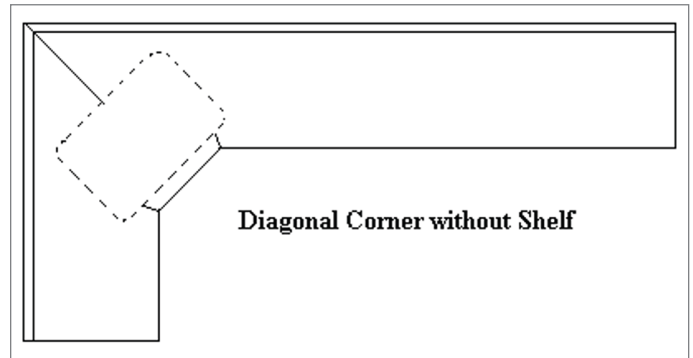

When measuring for a diagonal sink front, provide the cabinet dimensions. Drawing to the right shows 36" x 36" cabinet dimensions.

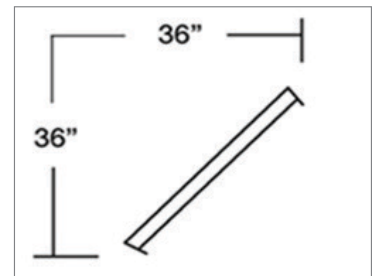

U-Shape and L-Shape Kitchens with Bars
Based on 24” deep cabinets and 25” deep countertops*

* For 25 1/4" tops, add 10 3/4" to cabinet measurement for 36" bar.
* Add 1 1/4" to cabinet measurement for standard 26 1/2" bar.

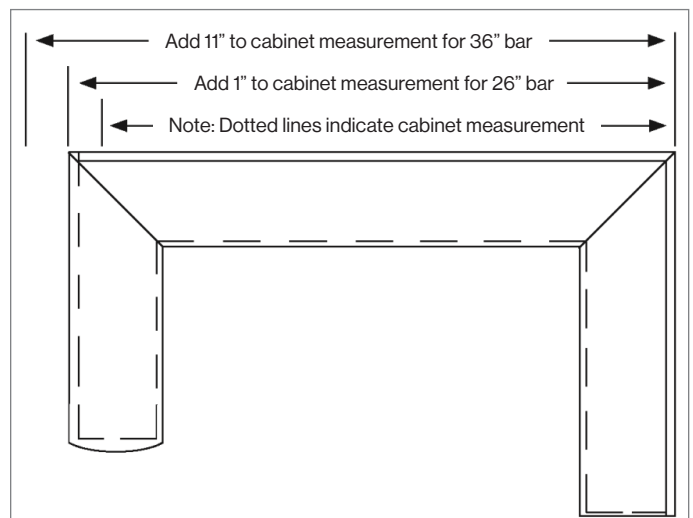



Extended countertops over 12 feet

For tops over 12 feet a “Y” seam is used for strength, better front-to-back match, and to keep the joint away from the heavy traffic in the sink area.

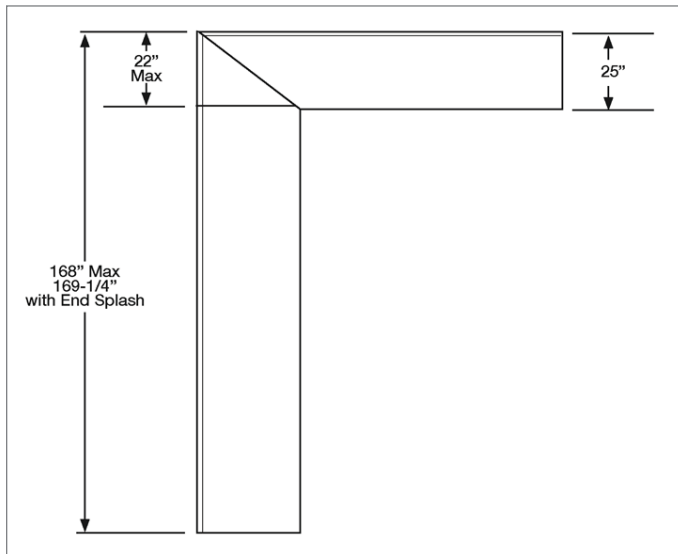

A slightly irregular bowed wall can be accepted as Hartson-Kennedy countertops have a 3/8" scribe which can be sanded or planed to fit bowed walls.

Waterfall and No-Drip 25 1/4" kitchen tops manufactured at Marion, Indiana plant have 5/8" scribe on the backsplash.

Countertop templates are required in certain situations, such as:

1. An unusual shape with several angles and/or radius corners;
2. A large L-shaped or U-shaped top that is badly out of square;
3. A countertop that follows angled walls.

In such situations, a properly made template will allow Hartson-Kennedy to cut the top right the first time, saving you and your customer additional time, cost and aggravation.

Many installers will perform this service for an additional fee.

MAKING AN ACCURATE TEMPLATE:

NOTE: Do not make templates out of paper.

They are likely to get torn, rolled up, folded or have smashed corners where sharp angles are needed. Example of paper template below:



Template material — for best results countertop templates should be assembled using heavy corrugated cardboard.

Full size templates — make template of the actual cabinets; do not attempt to make a template of the countertop itself. Send a separate drawing of the countertop with all dimensions, and mark the drawing: "SEE TEMPLATE".

1. Mark the correct overall dimension on each section.
2. Indicate the amount of overhang desired at open ends.
3. Show the centerline location of any cutouts required.
4. Any template larger than 8' x 6' should be split in the middle of one wall. Mark the joint as in the example below – just as if it were assembled.
5. **Mark the template** with your account name, purchase order number and customer name.

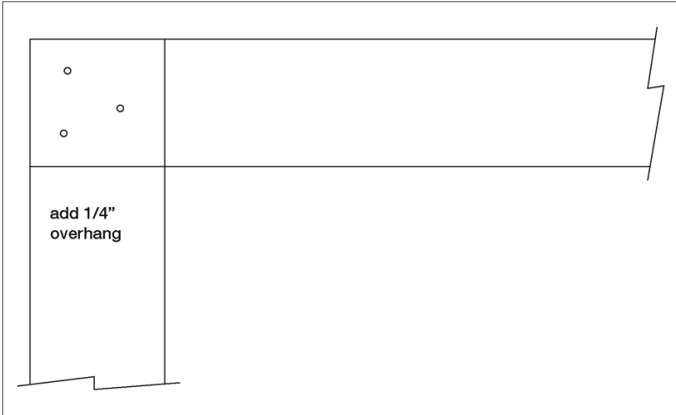

1. Lay cardboard at least 72" along each wall, making sure they meet in a well-defined angle (see **correct** figure).
2. Send a separate drawing of the countertop with all dimensions, and mark the drawing: "SEE TEMPLATE".
3. Mark the template with your account name, purchase order number and customer's name.

Overhang rules for allowing overhang on the ends of countertops:

1. On a countertop end that is open and capped: allow 1/4" to 1" overhang.
2. When a countertop butts to an appliance: allow 0 to 1/8" overhang.
3. When a countertop butts to a wall or cabinet: allow no overhang.

Corner or angle templates – construct a triangular template as follows:

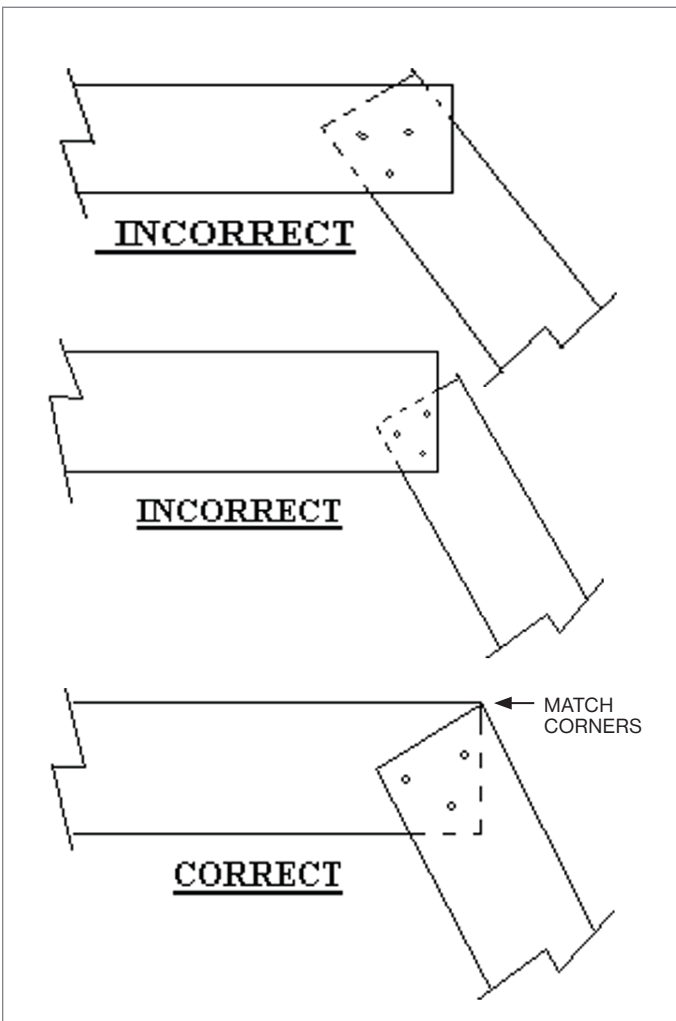

For best results countertop templates should be assembled using heavy corrugated cardboard. Mark the overall dimensions on each section. Indicate the amount of overhang desired at open ends. Show locations of any cutouts required. Example of properly submitted template below:

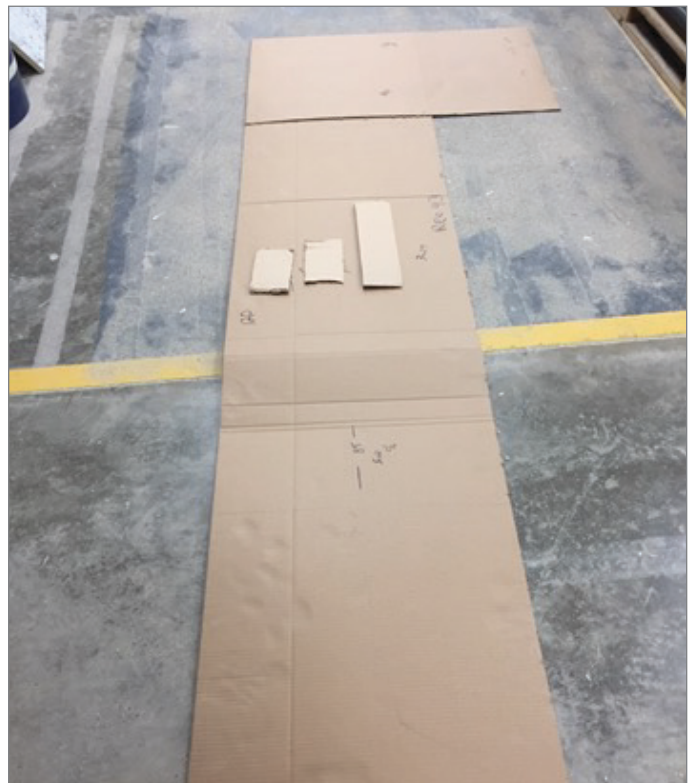



DISCLAIMER

This document gives general recommendations only. It serves as a general guide to good practice and constitutes no form of warranty or representation as to fitness for a particular purpose in respect of the products and processes described in it. Any information or products contained within this document must be verified and tested for suitability by the user for his or her particular purpose or specific application. Consideration needs to be given to local laws or regulations or specific circumstances. The content of this document reflects our knowledge and experience at the time of publication. The information provided in this document is solely indicative. We are unable to warrant the accuracy and completeness of this information. No rights can be derived from the information provided; the use of the information is at your own risk and responsibility. This document does not guarantee any properties of our products. We do not warrant that the information in this document is suitable for the purpose for which you consult it. Other than our express warranty, the document does not contain any design, structural calculation, estimate or other warranty or representation that may be relied on. Colors used in our communications (including but not limited to printed matter) and in samples of our products may differ from the colors of the products to be supplied. Our products and samples are produced within the specified color tolerances and the colors (of production batches) may differ, even if the same color is used. The viewing angle also influences the color perception. Customers and third parties must have a professional adviser inform them about (the suitability of) our products for all desired applications and about applicable laws and regulations. We reserve the right to change (the specifications for) our products without prior notice. The newest version of the document replaces all previous versions. We advise that the newest version may contain technical changes that must be taken into account when using the products. The latest version of the document may be consulted on our website (www.hartson-kennedy.com).

You should always check whether an updated version of the document is available.

Any warranty on the products may be voided if the (contents of the) latest version of this document, which may be updated from time to time, is not (properly) followed. We have made every effort to ensure the accuracy of the information in this document, but we cannot be held liable for any oversights, inaccuracies or typographical errors. To the maximum extent permitted under the applicable law, we shall not be liable (neither contractual nor non-contractual) for any damage arising from or related to the use of this document, except if and to the extent that such damage is the result of willful misconduct or gross negligence on our part. All our oral and written statements, offers, quotations, sales, supplies, deliveries and/or agreements and all related activities are governed by our general terms and conditions. All intellectual property rights and other rights regarding the content of this document (including logos, text and photographs) are owned by us and/or our licensors.

Hartson-Kennedy Inc.

522 West 22nd Street
Marion, IN 46953
(765) 668-8144
www.hartson-kennedy.com